

Specifications

| | P501X | P451X | P451W | P401W | PE501X |
|---|---|---|---------------------|---------------------|---------------------|
| LCD Panel | 1024 x 768 pixels | | 1280 x 800 pixels | | 1024 x 768 pixels |
| Resolution ¹ | 1024 x 768 pixels | | 1280 x 800 pixels | | 1024 x 768 pixels |
| Lens | Manual Focus / F=1.7 to 2.2, f=17.4 to 29.0 mm Throw ratio 1.3 to 2.2 | | | | |
| Lamp ² (Eco Mode On / Eco Mode Off) | 163 W / 270 W | 163 W / 240 W | 163 W / 240 W | 163 W / 240 W | 163 W / 270 W |
| Lens shift | 0 ~ +0.5V | 0 ~ +0.5V | 0 ~ +0.6V | 0 ~ +0.6V | 0 ~ +0.5V |
| Lamp Life ² (Eco Mode On / Eco Mode Off) | 6000 H / 3500 H | 6000 H / 4000 H | 6000 H / 3500 H | 6000 H / 4000 H | 6000 H / 3500 H |
| Image Size | 25 to 300 inches | | | | |
| Colour reproduction | 10 bit signal processing, 1.07 billion colours (viewer, Network, 16.7 million colours) | | | | |
| Light Output ³ - ⁴ | Eco Mode Off | 5000 ANSI lumens | 4500 ANSI lumens | 4500 ANSI lumens | 4000 ANSI lumens |
| | Eco Mode On | Approx.60 % | Approx.67 % | Approx.67 % | Approx.60 % |
| Contrast Ratio (white / black) ⁴ | 4000 : 1 with iris | | | | |
| Maximum Resolution | WUXGA (1920 x 1200) with Advanced AccuBlend | | | | |
| Scan Rate | Horizontal: 15 to 100 KHz (RGB: 24 kHz or over), Vertical: 50 to 120 Hz | | | | |
| Keystone Correction | Horizontal/ Vertical : Approx. ±30 degree | | | | |
| Input Terminals | Computer | 1 x Mini D-Sub 15 pin 1 x Stereo mini Jack | | | |
| | Video | 1 x RCA | | | |
| | Audio | 2 x RCA | | | |
| | S-Video | 1 x Mini Din 4 pin | | | |
| | Audio | 2 x RCA (shared with Video) | | | |
| | HDMI | 2 x HDMI | | | |
| | Audio | HDMI or Stereo Mini Jack (Computer Audio IN) | | | |
| | Mic | 1 x Mini Jack | | | |
| Output Terminals | Audio | 1 x Mini D-Sub 15 pin 1 x Stereo Mini Jack | | | |
| Wired LAN port | 1 x RJ-45 (10BASE-T / 100BASE-TX) | | | | — |
| Wireless LAN port | Yes | | | | — |
| Control Terminals | 1 x D-sub 9 pin | | | | |
| USB Port (for USB Display) | 1 x Type A, 1 x Type B | | | | 1 x Type B |
| Built-in speaker | 16 W monaural | | | | |
| Environment | Operation Temperature | 5°C-40°C ((ECO MODE) is set automatically to [ON] at 35°C to 40°C), 20% to 80% Humidity (Non-Condensing) | | | |
| | Storage Temperature | -10°C-50°C, 20 %-80 % Humidity (Non-Condensing) | | | |
| Power requirement | 100 to 240 V AC, 50 Hz / 60 Hz | | | | |
| Input Current (100 - 130 V / 200 - 240 V) | 4.2 A to 1.7 A | 3.9 A to 1.6 A | 4.2 A to 1.7 A | 3.9 A to 1.6 A | 4.2 A to 1.7 A |
| Power Consumption (100 - 130 V / 200 - 240 V) | Eco Mode Off | 374 W / 357 W | 341 W / 325 W | 374 W / 357 W | 341 W / 325 W |
| | Eco Mode On | 260 W / 248 W | | | 253 W / 241 W |
| | Standby Mode(power saving) | 0.21 W / 0.43 W | | | |
| Calorific Value (100 - 130 V / 200 - 240 V) | 1276 BTU / 1218 BTU | 1164 BTU / 1109 BTU | 1276 BTU / 1218 BTU | 1164 BTU / 1109 BTU | 1252 BTU / 1194 BTU |
| Net Dimensions (W x H x D) | 398 x 115 x 282 mm | | | | — |
| Weight | 4.1 kg | | | | 4.0 kg |
| Packing Dimensions (W x H x D) | 478 x 390 x 233 mm | | | | — |
| Packing Weight | 5.5 kg | | | | 5.4 kg |
| Accessories | Power cord, Remote control, Batteries, Signal cable, CD-ROM (User's manual, Utility software), Security sticker | | | | |
| Regulations | For United States | UL Approved (UL 60950-1), Meets FCC Class B Requirements | | | |
| | For Canada | C-UL Approved (CSA 60950-1), Meets DOC Canada Class B Requirements | | | |
| | For Europe | Meets low voltage directive (EN60950-1, TÜV GS approved), (Meets EN55022 ClassB, EN55024, EN61000-3-2, EN61000-3-3) | | | |
| | For Asia / Oceania | IEC60950-1, Meets AS/NZS CISPR.22 Class B | | | |
| | For Korea | KC (safety : K60950-1, EMC : K00022, K00024) | | | |
| | For China | GB4943, GB9254, GB17625.1 | | | |
| | For Russia | Gost R 60950-1 | | | |

¹: Effective pixels are more than 99.99%.

²: Lamp life is defined as the average time span for the brightness of the lamp to be reduced by half, it does not refer to the warranty period for the lamp.

³: This is the light output value (ANSI lumens) when the [PRESET] mode is set to [HIGH-BRIGHT]. If any other mode is selected as the [PRESET] mode, the light output value may drop slightly.

⁴: Compliance with ISO21118-2005

All specifications are subject to change without notice.

● Throw Distance and Screen Size

(Image is WXGA)

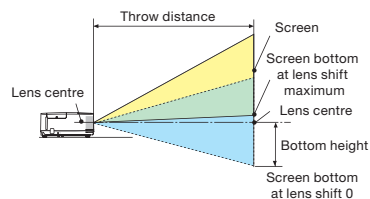

P501X/P451X/PE501X (Aspect ratio 4:3)

| Screen size (m) | Throw distance (m) | | Bottom height (cm) | |
|-------------------|--------------------|-------|--------------------|-----------------------|
| | Wide | Tall | At Lens Shift 0 | At Lens Shift Maximum |
| 30 (0.61x 0.46) | 0.78 | 1.33 | -22.9 | 0 |
| 40 (0.81x 0.61) | 1.06 | 1.79 | -30.5 | 0 |
| 60 (1.22x 0.91) | 1.62 | 2.71 | -45.7 | 0 |
| 80 (1.63x 1.22) | 2.17 | 3.64 | -61.0 | 0 |
| 100 (2.03x 1.52) | 2.73 | 4.56 | -76.2 | 0 |
| 120 (2.44x 1.83) | 3.29 | 5.49 | -91.4 | 0 |
| 150 (3.05x 2.29) | 4.12 | 6.87 | -114.3 | 0 |
| 200 (4.06x 3.05) | 5.51 | 9.18 | -152.4 | 0 |
| 240 (4.88 x 3.66) | 6.62 | 11.03 | -182.9 | 0 |
| 300 (6.10 x 4.57) | 8.29 | 13.79 | -228.6 | 0 |

The values in the tables are design values and may vary.

P451W/401W (Aspect ratio 16:10)

| Screen size (m) | Throw distance (m) | | Bottom height (cm) | |
|-------------------|--------------------|-------|--------------------|-----------------------|
| | Wide | Tall | At Lens Shift 0 | At Lens Shift Maximum |
| 30 (0.65x 0.40) | 0.83 | 1.41 | -20.2 | 4.0 |
| 40 (0.86x 0.54) | 1.12 | 1.89 | -26.9 | 5.4 |
| 60 (1.29x 0.81) | 1.71 | 2.83 | -40.4 | 8.1 |
| 80 (1.72x 1.06) | 2.29 | 3.85 | -53.8 | 10.8 |
| 100 (2.15x 1.35) | 2.89 | 4.82 | -67.3 | 13.5 |
| 120 (2.59x 1.62) | 3.47 | 5.87 | -80.8 | 16.2 |
| 150 (3.23x 2.02) | 4.35 | 7.26 | -101.0 | 20.2 |
| 200 (4.31x 2.69) | 5.82 | 9.69 | -134.6 | 26.9 |
| 240 (5.17 x 3.23) | 6.99 | 11.65 | -161.5 | 32.3 |
| 300 (6.46 x 4.04) | 8.76 | 14.58 | -201.9 | 40.4 |

The values in the tables are design values and may vary.

● Cabinet Dimensions

(unit: mm)

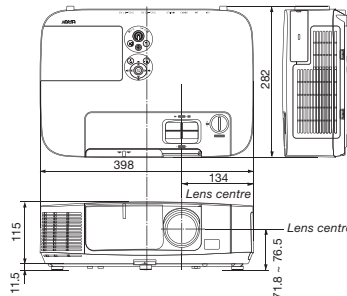

● Options

Replacement lamp
NP23LP
Cable cover
NP03CV

Wireless LAN unit*
NP02LM1
NP02LM2
NP02LM3

* Please make sure to choose the appropriate wireless LAN unit according to the below list in use country or area.

| | |
|---------|---|
| NP02LM1 | United States, Canada, Mexico, Taiwan, Brazil, Colombia |
| NP02LM2 | Europe, United Arab Emirates, Saudi Arabia, Oman, South Africa, Turkey, Ukraine, Egypt, Israel, Australia, New Zealand, Japan, Thailand, China, Hong Kong, Singapore, South Korea, Sri Lanka, Pakistan, Vietnam, India, Indonesia, Philippines, Peru, Chile, Argentina, Ecuador |
| NP02LM3 | Russia |

* In case of used in Malaysia, NP02LM2 has been certified but SIRIM certification sticker should be attached on LAN unit. Please contact your partner in Malaysia before it use.



The projector can be unplugged during its cool down period after it is turned off.
Parts of the projector will become heated during operation. Use caution when picking up the projector immediately after it has been operating.
Use caution when putting the projector in the soft case immediately after the projector has been operating. The projector cabinet is hot.

● Virtual Remote Tool uses Win2C/DDC library, ©Nicomsoft Ltd.

● HDMI, the HDMI Logo and High-Definition Multimedia Interface are trademarks or registered trademarks of HDMI Licensing LLC.

● Wi-Fi is registered trademark of the Wi-Fi Alliance.

● Crestron and Crestron RoomView are trademarks or registered trademarks of Crestron Electronics, Inc.

● Trademark PULink is a trademark applied for trademark rights in Japan, the United States of America and other countries and areas.

All other trademarks are the property of their respective owners.
The images in this brochure are samples.



Cat.No. WLPJ-1303-312NN

Empowered by Innovation

NEC

Installation projector

P501X/P451X/P451W/P401W/PE501X

High brightness, high contrast ratio, multi-function projectors, designed for installation in large conference rooms and auditoriums



<http://www.nec-display.com/ap/>

High brightness, high contrast ratio, multi-function projectors, designed for installation in large conference rooms and auditoriums



Features designed to make installation easier

Keystone correction

This model has two types of keystone corrections. One is built-in Horizontal / Vertical keystone*1 and pincushion correction*2.

*1 Both keystone for Horizontal and Vertical can be used simultaneously.
*2 Pincushion function cannot be used with other keystone functions.

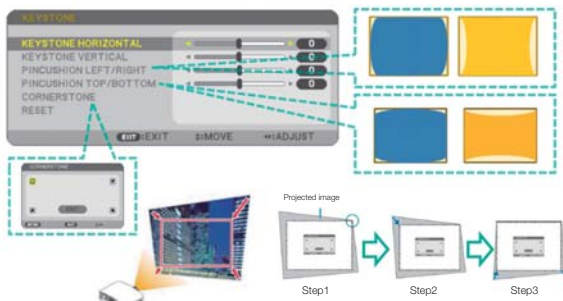

The other is the geometric correction tool (GCT) in the Image Express Utility Lite software that has more functions such as 4 points, multi-points and parameter corrections. Those allow you to correct almost all distortions in the image.

*Image Express Utility Lite for MAC is not supported.

Vertical lens shift and 1.7x zoom for flexibility of the installation

The projector is equipped with a lens shift function that can easily move the position of the projected image up or down by rotating a dial left or right, which means that the projector does not have to be moved. The projector also supports a 1.7x zoom to cover a wide throw distance. When combined with the lens shift mechanism, this makes ceiling mountings much easier.

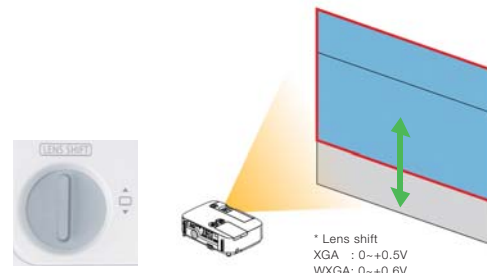

* Lens shift
XGA : 0~+0.5V
WXGA: 0~+0.6V

Advanced functionality designed for wide range of connection and networking

Streaming video transfer capability (for Windows)

Image Express Utility Lite allows you to send streaming video from the computer to a single projector over wired or wireless LAN without the need of connecting computer cable.

Wireless Image Utility (WIU) for iOS wireless image transmission

WIU can send image from your iOS devices such as iPad®, iPhone® and iPod touch®.

This application has annotation, pointing and magnifying. WIU is available in infrastructure and Ad-hoc connection.



More network capability

| Network capability | Transmission Image | Audio | Streaming Video | USB Display | Geometric correction | Annotation | Pointer | Meeting |
|--|--------------------|-------|-----------------|-------------|----------------------|------------|---------|---------|
| Image Express Utility lite for Windows | ✓ | ✓ | ✓ (Push) | ✓ | ✓ | | | |
| Image Express Utility lite for Mac | ✓ | | | | | | | |
| Wireless Image Utility | ✓ | | | | | ✓ | ✓ | |
| Image Express Utility 2.0 | ✓ | | | | | | ✓ | ✓ |

Application software can be downloaded from our web site at http://www.nec-display.com/dl/en/pj_soft/lineup.html
The compatible software is scheduled to be released in the E/Apr.

Various interfaces

- Two HDMI connectors*
- Wired /Wireless LAN Port
- USB port for viewer function

Computer free presentation

| | |
|---------------------------|-------------------------------|
| Supported graphic formats | jpg, jpe, jpeg, bmp, png, gif |
| Supported movie files | mpg, mpeg, wmv, mp4*1 |
| Supported computer files | pdf, ppt, pptx*2, xls, xlsx*2 |

*1 Windows media player 11 cannot playback mp4 files.
*2 EXCEL and PowerPoint files are available for 97-2007 version only.

USB Display with audio transfer (Windows only)*

Using a commercially available USB cable (compatible with USB 2.0 specifications) to connect the computer with the projector allows you to send your computer screen image and audio to the projector.



Crestron Roomview supported

Equipped with an abundance of basic functionality

16W built-in speaker for an integrated audio solution

Powerful 16W monaural speaker provides volume needed for large rooms. A MIC input is useful for your presentation in a conference room or lecture in a classroom.

* The MIC input does not support plugin power microphones.



Equipped with an Auto Eco Mode to automatically control lamp power

Auto Eco Mode automatically adjusts the brightness to suit the ambient light environment. This function can reduce the power consumption by up to 24%. Both the projector and its remote control are equipped with an Eco button for easy selection of Eco Mode.

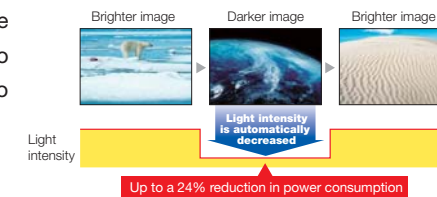

Equipped with a high performance filter

The large filter has the two-layer construction. It provides excellent dust protection.



No signal information

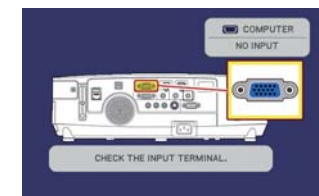

Lamp life up to 6,000H (Eco mode)

Contrast ratio 4000:1

Carbon Meter

DICOM-SIM. supported

* Cannot be used for medical diagnosis.

Quick start, Quick Power Off, Direct Power Off

Various security functions

- Keyword protection
- Cabinet control panel locks
- Security slot
- Security chain opening

Terminals

P501X/P451X/P451W/P401W

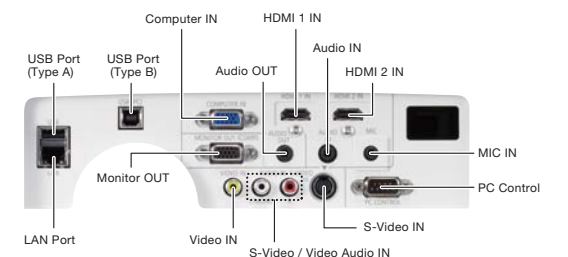

PE501X

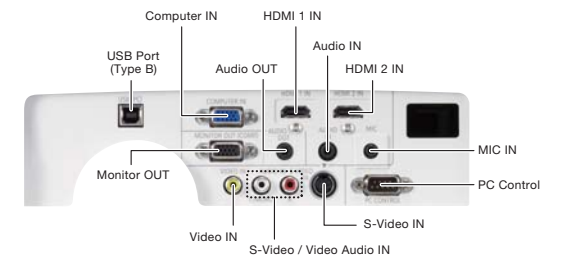

P501X

5000 ANSI lumens XGA 4.1 kg

P451W

4500 ANSI lumens WXGA 4.1 kg

P451X

4500 ANSI lumens XGA 4.1 kg

P401W

4000 ANSI lumens WXGA 4.1 kg

PE501X

5000 ANSI lumens XGA 4.0 kg